

## FICHA TÉCNICA DATA SHEET FICHA TÉCNICA



### 24V LED STRIPS ACCESSORIES. RF single-color remote control

Mando monocolor RF 4 zonas  
RF single-color remote control 4 zones  
Control remoto RF 1 cor 4 cores

**5**  
YEAR  
WARRANTY

**IP20**

**-30° | +55°**

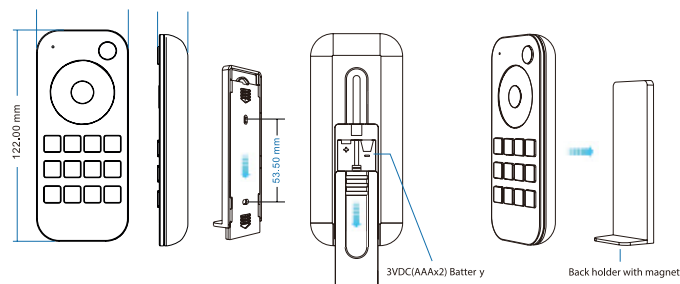

**FT-2801  
F2888**

Output signal	RF(2.4GHz)
Working voltage	3VDC(AAAx2)
Working current	<5mA
Standby current	<10 $\mu$ A
Standby time	1 year
Remote distance	30m